



Three Parkway | Availabilities

1601 Cherry Street • Philadelphia, PA

Floor 7

Suite 700

Size 27,520 RSF

Full floor available

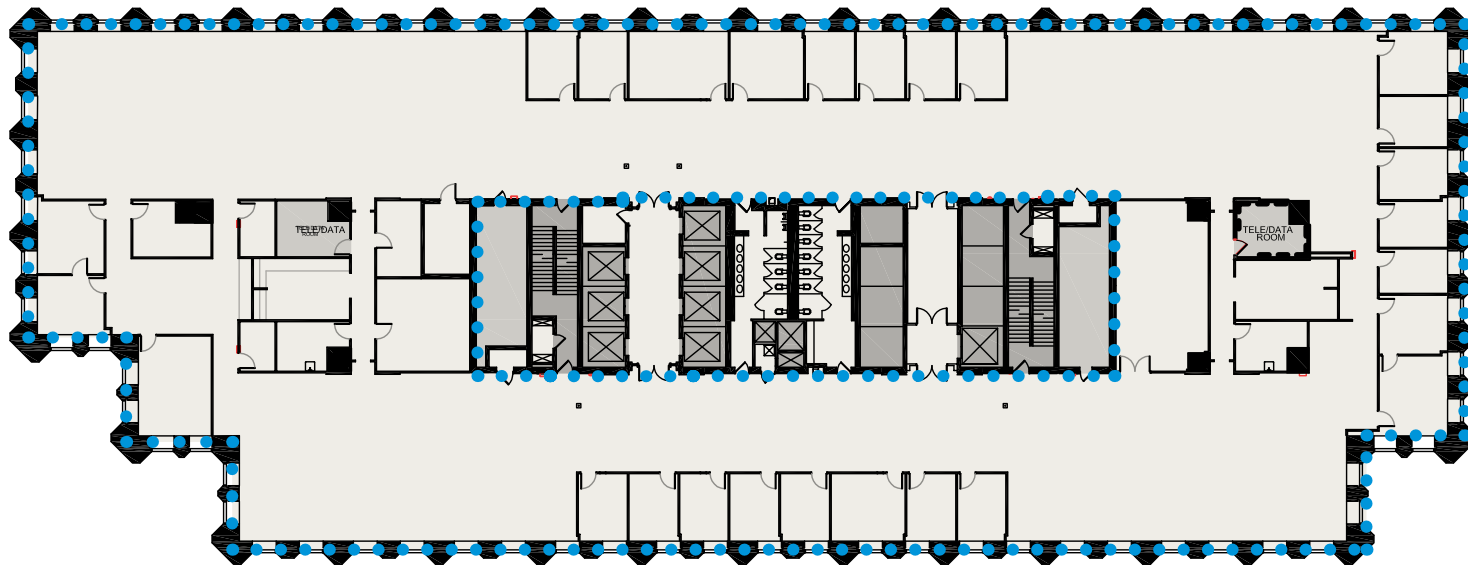

For Leasing Information

Alex Breitmayer

Senior Vice President
+1 215 399 1813
alex.breitmayer@am.jll.com

Josh Sloan

Managing Director
+1 215 988 5554
joshua.sloan@am.jll.com

David Healy

Executive Vice President
+1 215 988 5555
david.healy@am.jll.com

JLL | Jones Lang LaSalle

1650 Arch Street Suite 2500
Philadelphia, PA, 19103
+1 215 988 5500



MRP | REALTY